

KWIKSET HANDLESET

Door Prep	Deadbolt: Cross Bore 2-1/8" or 1-1/2". Edge Bore 1". Latch Face 1" x 2-1/4". Handle: Cross Bore 2-1/8" Edge Bore 1". Latch Face 1" x 2-1/4".
Backset	Deadbolt: Adjustable to 2-3/8" or 2-3/4". Handle: Adjustable to 2-3/8" or 2-3/4".
Door Thickness	1-3/4" doors standard. 2-1/4" doors optional.
Cylinder	5-pin. Pin & Tumbler Only.
Faceplate	1" x 2-1/4". Specify round corner, square corner or drive-in.
Strikes	Deadbolt: 1" x 2-1/4". Specify round corner or square corner. Other options available. Handle: 2-1/4" full lip. Specify round corner or square corner. Other options available.
Bolt	Deadbolt: 1" throw. Handle: 1/2" throw.
Door Handing	Reversible for right or left-hand doors. Specify handing when ordering all levers as interior trim for exterior doors.
ANSI/BHMA	A156.5 Grade 3 for deadbolt.
ADA	N/A
UL	N/A

KWIKSET LEVER

Door Prep	Cross Bore 2-1/8". Edge Bore 1". Latch Face 1" x 2-1/4".
Backset	Adjustable to 2-3/8" or 2-3/4". UL 2-3/4" standard 2-3/8" optional.
Door Thickness	1-3/8" – 1-3/4" doors standard. 2-1/4" doors optional on 200 and 400 functions only.
Cylinder	5-pin. Pin & Tumbler Only.
Faceplates	1" x 2-1/4". Specify round corner, square corner or drive-in.
Strikes	2-1/4" full lip. Specify round corner or square corner. Other options available.
Bolt	Nickel Plated.
Door Handing	Delta and Dorian are non-handed.
ANSI/BHMA	A156.2 Grade 3.
ADA	Functions 200, 420, 488 satisfy section 4.13.9 ADA requirements.
UL	Meets 3 hour fire rating for all UL lever functions.

KWIKSET DEADBOLTS

Door Prep	660, 665: Crossbore 2-1/8". Edge Bore 1". Latch Face 1" x 2-1/4". 663: Crossbore 1-5/8". Edge Bore 1". Latch Face 1" x 2-1/4". 667: Crossbore 2-1/8" or 1-1/2". Edge Bore 1". Latch Face 1" x 2-1/4".
Backset	660, 665, 667: Adjustable latch standard. 663: 2-3/8" standard. 2-3/4" optional.
Door Thickness	660, 663, 665, 667: 1-3/8" – 1-3/4" doors standard.
Cylinder	660, 665: 5-pin. Pin & Tumbler standard. Available in SmartKey.
Faceplates	1" x 2-1/4". Specify round corner, square corner or drive-in.
Strikes	1" x 2-1/4" full. Specify round corner or square corner. Other options available.
Bolt	1" throw.
Door Handing	Reversible for right or left-hand doors.
ANSI/BHMA	660, 663, 665: A156.5 Grade 3.
ADA	Interior turn piece meets 4.13.9 ADA requirements.
UL	N/A

KWIKSET KNOBS

Door Prep	Cross Bore 2-1/8". Edge Bore 1". Latch Face 1" x 2-1/4".
Backset	Adjustable to 2-3/8" or 2-3/4"
Door Thickness	1-3/8"–1-3/4" doors standard.
Cylinder	5-Pin Pin & Tumbler standard. Cove knob also available in SmartKey
Faceplates	1" x 2-1/4". Specify round corner, square corner or drive-in.
Strikes	2-1/4" full lip. Specify round corner or square corner. Other options available.
Bolt	1/2" throw for all functions.
Door Handing	Reversible for right or left-hand doors.
ANSI/BHMA	A156.2 Grade 3.
ADA	N/A
UL	N/A

KWIKSET HANDLESET

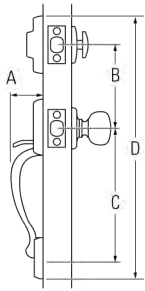

Design	A	B	C	D
Dakota™	2-1/4"	5-1/2"	8-13/32"	17-5/8"
Farmington®	2-9/16"	5-1/2"	8-13/32"	17-7/16"

KWIKSET KNOBS

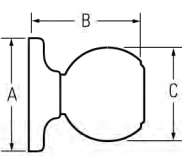

Design	A	B	C
Cove™	2-5/8"	2-1/2"	2-1/4"
Polo®	2-5/8"	2-3/4"	1-7/8"
Tylo®	2-5/8"	2-3/8"	1-7/8"
Valiant®	2-5/8"	2-1/4"	1-7/8"

KWIKSET LEVER

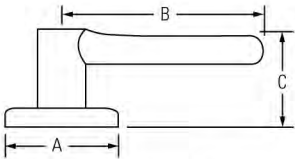

Design	A	B	C	C (Keyed)
Delta™	2-5/8"	3-5/8"	1-15/16"	2-5/8"
Dorian®	2-5/8"	3-3/4"	2-1/4"	2-5/8"

KWIKSET DEADBOLTS

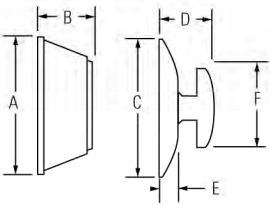

Design	A	B	C	D	E	F
660	2-1/2"	1-1/8"	2-1/2"	1"	3/8"	1-3/4"
663			2-1/2"	1"	3/8"	1-3/4"
665	2-1/2"	1-1/8"	2-1/2"	1-1/8"		
667	2-1/2"	3/8"	2-1/2"	1"	3/8"	1-3/4"
677	2-1/2"	3/8"	2-1/2"	1"	3/8"	1-3/4"