

Model No :: **50030LEDD-BS/FST**  
 Name :: Vision



Project Name :: \_\_\_\_\_  
 Location :: \_\_\_\_\_  
 Type :: \_\_\_\_\_  
 Quantity :: \_\_\_\_\_  
 Notes :: \_\_\_\_\_

**Product Information**

Product ID :: 50030  
 UPC Code :: 641594183771  
 Mounting Type :: Ceiling  
 Finish :: Brushed Steel (BS)  
 Diffuser :: Frosted (FST)

*See Page 2 for Custom Product Options*

**Product Dimensions**

|                       |  |                 |
|-----------------------|--|-----------------|
| <b>Fixture</b>        |  | <b>Canopy</b>   |
| Length :: 9.5"        |  | Length :: 4.6"  |
| Width :: 9.5"         |  | Width :: 6.9"   |
| Diameter :: N/A       |  | Diameter :: N/A |
| Extension :: N/A      |  | Height :: 1.25" |
| Height :: 3.25"       |  |                 |
| Overall Height :: N/A |  |                 |



**Technical Specifications**

|   |   |  |   |
|---|---|--|---|
| <p><b>Qualifications</b></p> <p>Location Rating :: Ceiling<br/>         Certification :: cETLus<br/>         IES File :: Yes<br/>         Title 24 :: Yes<br/>         Energy Star :: Yes<br/>         ADA Compliant :: No<br/>         Marine Grade :: No<br/>         Emergency Lighting :: No<br/>         Warranty :: 5 Year<br/>                           Manufacture</p> | <p><b>Specifications</b></p> <p>Frame Material :: Metal<br/>         Diffuser Material :: Glass<br/>         Lamping Type :: N/A<br/>         Lamping Base :: SSL<br/>         Lamp Quantity :: 1<br/>         Lamp Wattage :: 17 W<br/>         Total Wattage :: 17 W<br/>         Lamps Included :: Yes<br/>         J-Box Type :: Standard 4</p> | <p><b>Voltage</b></p> <p>Voltage :: 120v</p> <p><b>Photometrics</b></p> <p>CCT :: 3000K<br/>         CRI :: 90<br/>         Wattage :: 17<br/>         Nominal Lumens :: 1440<br/>         Delivered Lumens :: 900</p> | <p><b>Recommended Dimmers</b></p> <p>(ELV) LEGRAND Paddle ADPD453LM2; (ELV) LEVITON Renoir II AWSMT-EA; (ELV) LUTRON Diva DVELV-300P; (ELV) LUTRON Diva DVELV-303P; (ELV) LUTRON Skylark SELV-300P; (TRIAC) LUTRON Diva DV-600P</p> |
|---|---|--|---|

**Line Drawing #1**

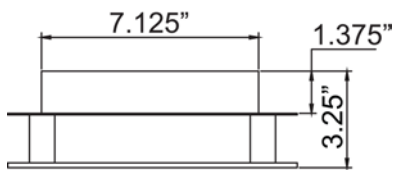

**Line Drawing #2**

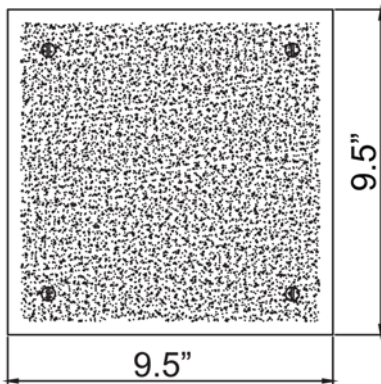

**IES File**

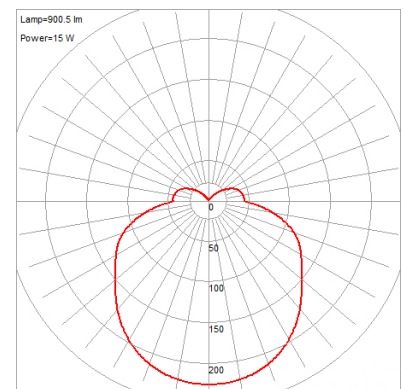

**Toll Free 800-828-5483 or www.AccessLighting.com**

14410 Myford Road, Irvine, CA 92606

The information provided is subject to change without notice. ©2018 Access Lighting Corporation. All Rights Reserved  
 Rev. 4/6/2018   Filename:: 50030LEDD-BS\_FST.pdf

