

# LED DOWNLIGHT INSTALLATION INSTRUCTIONS

Read the instruction sheet and all product labels before installing fixture. This product must be installed in full accordance with applicable electrical and building codes by a person familiar with the construction and operation of this fixture and all involved hazards. Installation should be performed by a qualified electrician in accordance with the National Electrical Code and relevant local codes.

**TO PREVENT ELECTRICAL SHOCK, POWER SHOULD BE TURNED OFF AT THE FUSE BOX BEFORE INSTALLATION.**

## SAFETY WARNINGS:

**Read all product labels and directions.**

- WARNING - Risk of fire or electric shock. LED Retrofit Kit installation requires knowledge of luminaires electrical systems. If not qualified, do not attempt installation. Contact a qualified electrician.
- WARNING - Risk of fire or electric shock. Install this kit only in the luminaires that have the construction features and dimensions shown in the photographs and/or drawings.
- Installation should be performed only by a qualified electrician in accordance with the National Electrical Code and relevant local codes.
- Do not make or alter any open holes in an enclosure of wiring or electrical components during kit installation.
- WARNING - To prevent wiring damage or abrasion, do not expose wiring to edges of sheet metal or other sharp objects.
- Lamp replacement instructions shall indicate the manufacturer's custom lamp part number, and a method to order replacement lamps by phone, website and/or mail.
- The recessed luminaire is intended for mounting only in a covered ceiling (where only the led side of the luminaire will be exposed to damp or dry locations).
- **INSTALLATION SHOULD ONLY BE PERFORMED AFTER POWER TO THE FIXTURE HAS BEEN DISCONNECTED.**
- These instructions shall be included on an information sheet packaged with each unit.

## INSTALLATION INSTRUCTIONS:

**4 inch can** ("MIN. LAMP COMPARTMENT DIMENSIONS 4(DIA) Inch\*5.9(H) inch" or equivalent in format S24-L5.)

1. Reach inside the existing can, and screw the supplied connector into the socket within the can.
2. Snap the mounting springs into place as shown. You should not be able to remove mounting springs once installed.
3. Make the connection between the male and female orange connectors.
4. Push the disk fixture up into the existing can making sure that the wires are not pinched between the surface and the can.
5. Make sure the disk sits flush against the surface.

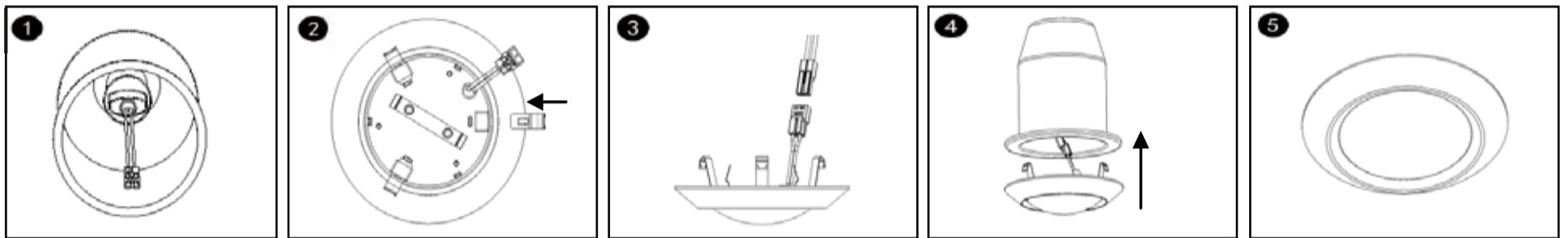

### Installation into (Halo) non-screw base recessed

- Start installation from Step 2.

### Replacing LED Module

1. Make certain power to can is turned off.
2. Pull down on trim with finger tips.
3. Disconnect LED orange connector.

### Title 24 Installation

For Title 24 installation please proceed with Step 2 of 4" Can installation.

## J-box

Min Volume: 18 in<sup>3</sup>, min Length: 3.25 in, Height: 2.20 in

1. Before installation, cut the wires close to the lamp holder part, leaving at least 9" of wire from the terminal part.
2. On the j-box, you will need to make 2 pigtail connections. The black j-box wire, which is the hot wire, should be connected to the black pigtail wire of the enclosed installation harness. The white j-box wire, which is the neutral wire, should be connected to the white pigtail wire.
3. Fasten the bracket to the j-box using the 1 1/2" or 3/4" 8-32. If necessary, use a drill to screw in tighter. Note that the #6 pointed screws can be used as a replacement for the bracket screws to help dig into surfaces harder than sheetrock such as wood.
4. It is time to make the connections. The green ground wire that is exposed and attached to the fixture should be cut at the end that is the free floating ring terminal and the insulation stripped 1/2" back. The uninsulated j-box wires are ground wires and will need to be connected to the green ground wire. Wire nuts should be used to make the connections. Next, make the connection between male and female black connectors. Finally make the connection between the male and female orange connectors. Carefully push all of the connections into the j-box, (**NOTE: IF POWER TO FIXTURE IS TURNED ON BEFORE CONNECTION OF MALE AND FEMALE BLACK CONNECTORS IS MADE THEN POWER SUPPLY WILL GO INTO SELF PROTECT MODE FOR 5 MINUTES. MAKE SURE POWER TO FIXTURE IS OFF AND TRY AGAIN AFTER 5 MINUTES.**)
5. Push the disk fixture up into the J-box, and make sure the bracket is installed well with the clips.
6. Make sure the disk sits flush against the surface.

