

**INSTALLATION INSTRUCTIONS FOR DUMMY KNOB OR LEVER.**

**INSTRUCTIONS D'INSTALLATION POUR BOUTON OU BEC-DE-CANE FACTICE.**

**INSTRUCCIONES DE INSTALACION PARA CHAPAS O MANIJAS FIJAS.**

**Drilling Instructions on reverse.**

*Instructions de Perçage au verso.*

*Instrucciones de Perforación al Reverso.*

**488**

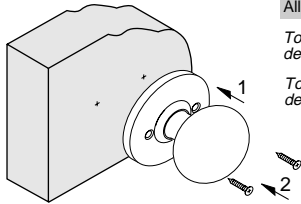

All knob designs.

*Toutes les formes de boutons.*

*Todos los diseños de chapas.*

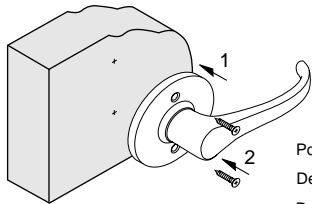

Portico (PL),  
Delta (DL) &  
Dorian (DNL)

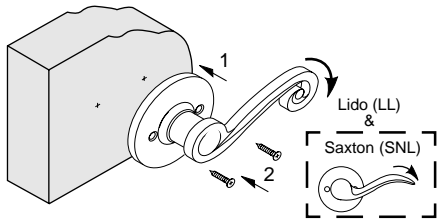

Lido (LL)  
&  
Saxton (SNL)

**489 & 491**

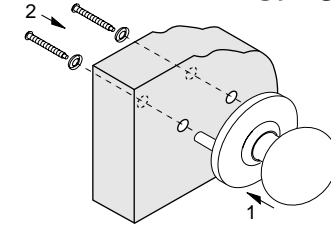

All knob designs.

*Toutes les formes de boutons.*

*Todos los diseños de chapas.*

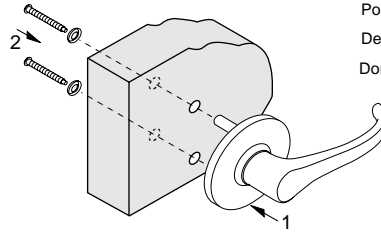

Portico (PL),  
Delta (DL) &  
Dorian (DNL)

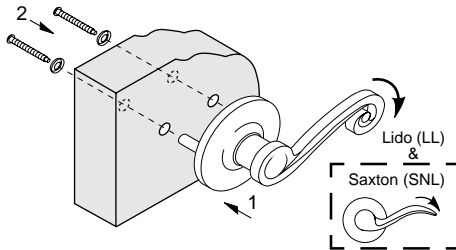

Lido (LL)  
&  
Saxton (SNL)

**487 & 490**

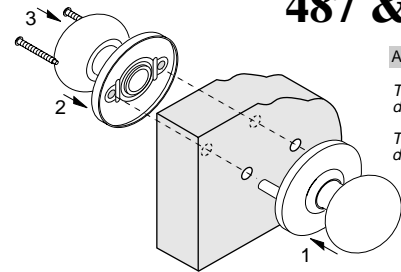

All knob designs.

*Toutes les formes de boutons.*

*Todos los diseños de chapas.*

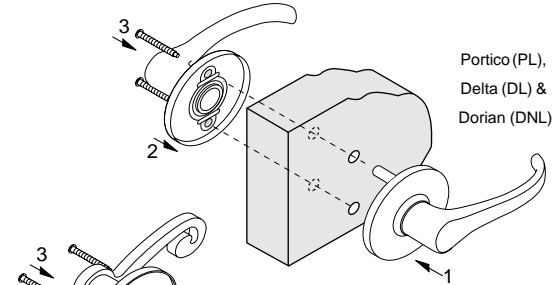

Portico (PL),  
Delta (DL) &  
Dorian (DNL)

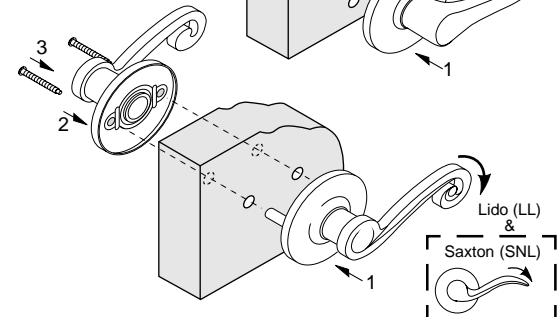

Lido (LL)  
&  
Saxton (SNL)

**TEMPLATE FOR NEW DOOR DRILLING.**  
**INSTALLATION INSTRUCTIONS ON REVERSE SIDE.**

**POUR LE PERÇAGE D'UNE PORTE NEUVE.**  
**INSTRUCTIONS D'INSTALLATION AU VERSO.**

**PLANTILLA PARA PERFORACION EN PUERTAS NUEVAS.**  
**INSTRUCCIONES DE INSTALACION AL REVERSO GABARIT.**

FOLD LINE FOR A 2-3/4" (70mm) BACKSET.

LIGNE DE PLIAGE POUR ÉCARTEMENT DE 2-3/4" (70mm).  
 LINEA DE DOBLEZ PARA DISTANCIA DE 2-3/4" (70mm).

FOLD LINE FOR A 2-3/8" (60mm) BACKSET.

LIGNE DE PLIAGE POUR ÉCARTEMENT DE 2-3/8" (60mm).  
 LINEA DE DOBLEZ PARA DISTANCIA DE 2-3/8" (60mm).

**1** Place desired fold line on door edge, with **centerline** approximately 38" (965mm) from floor.

Placer la ligne de pliage désirée sur le bord de la porte, l'axe étant à environ 38" (965 mm) du plancher.

Coloque la línea de doblez deseada sobre el borde de la puerta, con la **línea central** a aproximadamente 38" (965 mm) del piso.

Mark vertical locations for Portico, Dorian & Delta levers.

Marquer les positions verticales des leviers Portico, Dorian et Delta.

Marque la position vertical para manijas Portico, Dorian Y Delta.

Centerline

Axe

Linea central

Mark horizontal locations for all knobs, Lido & Saxton levers

Marquer les positions horizontales pour tous les boutons, les leviers Lido & Saxton.

Marque la position horizontal para todas las chapas y manijas Lido Y Saxton.

**2** Mark the appropriate screw hole centers, vertical or horizontal. For the (model 488) drill 1/8" (3mm) diameter pilot holes 3/4" (19mm) deep. (For models 487, 489, 490 and 491), drill 5/16" (8mm) diameter through holes.

Marquer les centres des trous de vis en vertical ou en horizontal. Pour le modèle 488, percez des trous de 1/8" (3 mm) et de 3/4" (19 mm) de profondeur. (Pour les modèles 487, 489, 490 et 491), percez des trous de 5/16" (8 mm) de diamètre.

**DIMENSIONS ON THIS PUBLICATION ARE NOT TO SCALE DO NOT USE THIS TEMPLATE TO MARK DISTANCES.**

Importado por:  
 Black & Decker S.A. de C. V.  
 Bosques de Cidros Acceso Radiatas #42  
 Col. Bosques de Las Lomas  
 CP 05120 Mexico, D.F.  
 Tel. 326-7100

Copyright © 1995 Kwikset Corporation  
 Copyright © 1998 Kwikset Corporation

Dummy Knob & Lever  
 02434-006/06