



# INSTALLATION INSTRUCTIONS

ACCESSIBLE SERIES — RECESSED MOUNTED

## Product Information

Recessed Accessible Features:

- Full length piano hinge
- Magnetic door catch
- Tilt mirror operates on heavy duty elbow hinges and a bottom piano hinge
- Bullet latch closure\*
- Adjustable glass shelves



---

\*\* Professional Installation is recommended to insure proper installation.

\*\* Please do not stand your medicine cabinet on end while unboxing. Lie the cabinet down mirror side up prior to installation. Set on a clean surface, like a towel or carpet to avoid damage.

\*\* Prior to discarding the packaging, locate shelves, door hardware, and screws where applicable.

---

## Installation Steps

\* Before installation, secure the door in the upright position using the bullet latch.

\*\* The cabinet is hinged on the left. A full-length piano hinge at the bottom of the cabinet and a bullet latch at the top of the cabinet secures the mirror to the cabinet body, allowing for the tilting feature.

1. Make sure the opening is plumb and level. A square and plumb installation insures proper operation of door. (Figure 1)
2. Make sure there is at least 1" of clearance above any obstructions (Figure 2)
3. Make sure the hinges are on correct side of opening for right hand operation. Place the medicine cabinet into rough wall opening. Make sure the cabinet flange covers rough wall opening evenly all around. (Figure 3)
4. Insert four wood screws into four locations provided for recessed installation. Be careful not to overtighten. Make sure cabinet is centered in rough wall opening. (Figure 4)

## NOTICE:

1. Do not install cabinet with damaged or broken glass. Contact the point of sale for further instructions on replacements.
  2. The installation instructions provided are for typical drywall/wood stud type walls. Additional hardware may/will be required for different wall types. Always make sure you adequately brace the cabinet for secure installation. Do not screw directly into drywall without proper bracing.
-

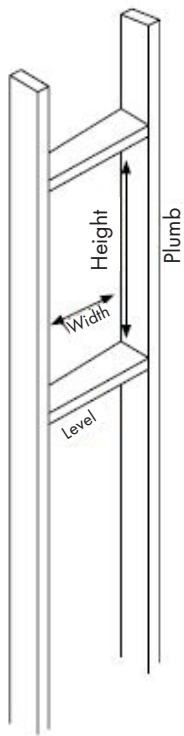

Fig. 1

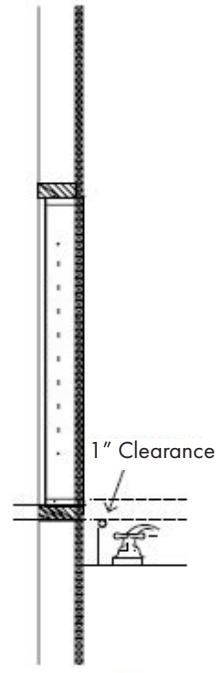

Fig. 2

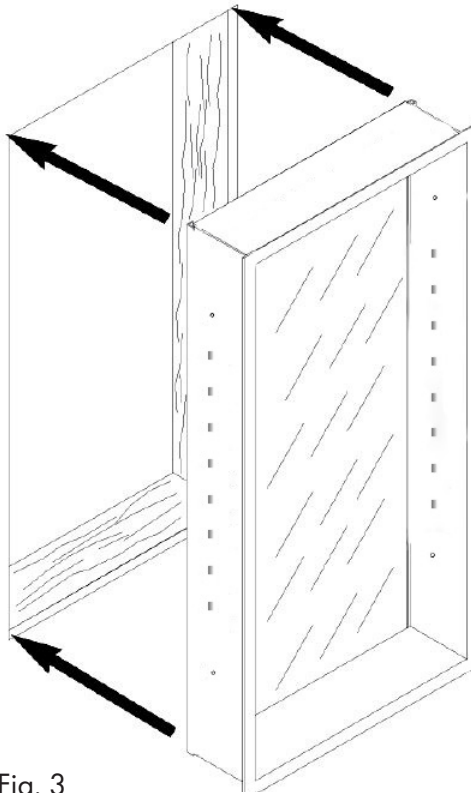

Fig. 3

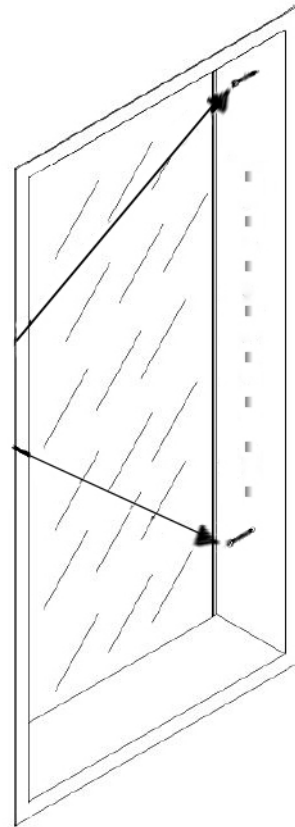

Fig. 4