

PK.1241

Congratulations!

With your purchase of your Full Dummy Set, you're among a group of discerning individuals who know the intrinsic value of selecting the finest—Baldwin.

Our step-by-step installation instructions will help guide you through your project quickly and easily.

Before you begin your installation, read and understand the installation instructions. If you have any questions, please do not hesitate to contact our Baldwin Consumer Help Line at 1-800-566-1986. We're here to help! We thank you for your purchase and wish you the fullest enjoyment of your Baldwin product.



Installation Instructions ENGLISH

MECHANICAL CONVERSION KIT FOR SECTIONAL DUMMY TRIMS



Remember Baldwin

With the completion of your project, remember that Baldwin quality hardware and giftware products are available for all your decorating and remodeling needs. Matching entrance sets for exterior doors, beautiful bath accessories, and a complete selection of cabinet and door-enhancing hardware are all available from your Baldwin retailer.

To request a product brochure or the name of a retailer near you, call 1-800-566-1986.

Canterbury®

Madison®



5305



5320

Logan™

Tahoe



5315



5325

Complimentary Baldwin Security Test and Rebate Offer

Be assured that your home is safe and secure with Baldwin's Security Test. To get yours free, download it at www.baldwinhardware.com/security and receive a special online rebate offer. Or write to Baldwin Hardware Corporation, P.O. Box 15048, Reading, PA 19612.

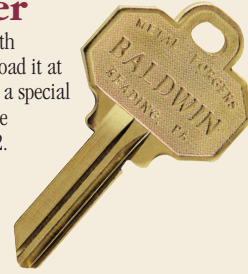

www.baldwinstyleguide.com

PK.1241
02/04/03

Baldwin offers a vast array of exceptional solid brass products to elegantly enhance all areas of the home. Each collection features a wide variety of beautiful, high-fashion finishes. From locking products to lighting and bath accessories, Baldwin provides the discriminating decorator with numerous options to accent and complement the home's ambience with distinction, taste, and fine detail.

PK.1241

1 Before You Begin

- Follow the step-by-step sequence to ensure proper operation of your Baldwin lockset.
- We recommend spreading cardboard over the floor to prevent scratching parts or floor.
- Always wear protective eyewear.

Note: The illustrations in these instructions depict the outside handle being installed on the right of the door. For installation of the outside handle on the left of the door, proceed as if all illustrations were reversed.

Your deadbolt trim can remain on the door during this conversion. No deadbolt components will be replaced.

Required Tools



Protective Eyewear



Phillips Screwdriver



Flat Head Screwdriver



Pliers

Helpful Tools



Putty Knife

Conversion Kit Parts

Verify that you have all parts pictured below. If parts are missing, please call the Baldwin Consumer Help Line at 1-800-566-1986.



Thumbpiece

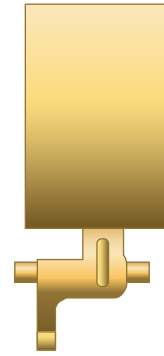

Thumbpiece
(Tahoe version only)

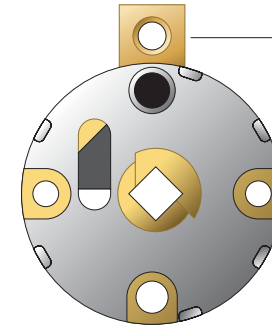

Thumblift Cartridge

Note:

Cartridge may or may not have a flange. This will not affect assembly or operation.



(2) #10-32 x 1 1/4"
Truss Head Screws



(2) #6-32 x 7/16"
Flat Head Screws

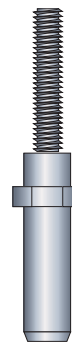

Lower Post



Allen Wrench

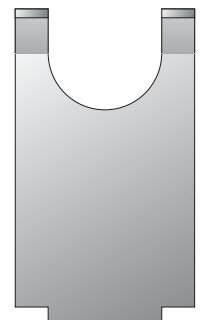

Rose Retainer Wrench
(Tahoe version only)

Exploded Views

Canterbury®
Logan®
Madison®

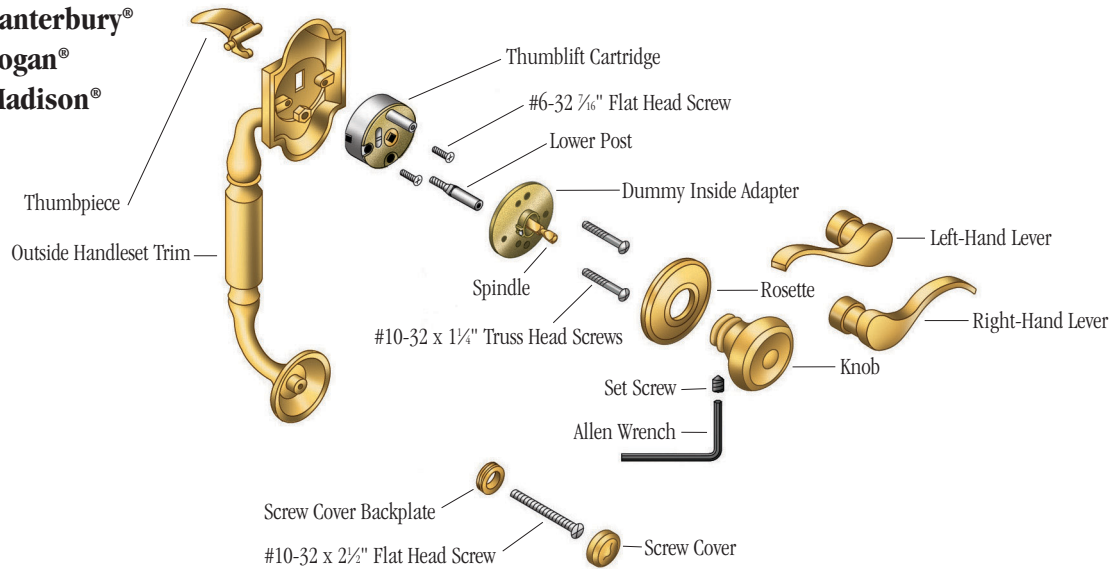

Tahoe

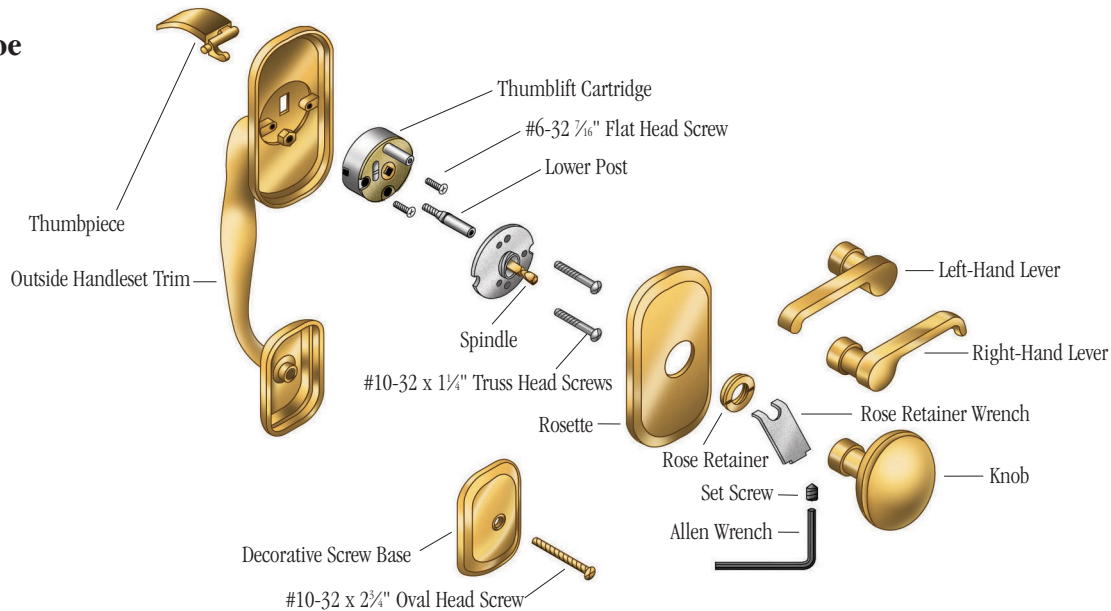

Troubleshooting Guide

Problem	Solution
Knob or lever keeps coming off the spindle.	Ensure that set screw on knob or lever is installed in V groove on spindle and securely tightened with Allen wrench provided. Refer to handleset installation step 4a (or step 4b for Tahoe).

Care and Maintenance

WARNING: Do not attempt to clean your hardware with any type of abrasive cleaners, solvents, or chemicals. These types of cleaning agents may mar the finish. A damp cloth is all that is necessary to wipe clean.

Note: Finish Number 102, Oil-Rubbed Bronze, can be cleaned with light machine oil and wiped with a dry cloth.

 **Consumer Help Line**
1-800-566-1986

Hours: 6 a.m. to Midnight C.S.T.—7 days a week
If you have trouble installing your Baldwin product, feel free to call our toll-free Consumer Help Line.

© Baldwin Hardware Corporation - A Masco Company
P.O. Box 15048, Reading, PA 19612

www.baldwinhardware.com

2 Remove Handleset from Door



1 Loosen the set screw using the Allen wrench provided. Remove the knob or lever from the spindle.



2 Unscrew the 1" round screw cover from its base.

Note: If you have a Tahoe design, do not remove the #10-32 x 2½" oval head screw securing the decorative screw base at this time.



Canterbury,
Logan, Madison

3a Remove the rosette from the adapter. Proceed to step 4.

Note: If your rosette is round and has a bottom slot as illustrated, insert a flat head screwdriver into bottom slot and pry off. If your rosette is round and does not have a slot, insert a flat edge tool (examples: putty knife, pocket knife, flat head screwdriver) between the rosette and your door and pry rosette off. Be careful not to mar the door or trim.

Tahoe



3b Unscrew the rose retainer that secures the rosette with the rose retainer wrench provided and remove.



4 Remove the screws securing the inside adapter. Remove inside adapter. Discard the screws. Keep adapter for re-installation.

Canterbury,
Logan, Madison



5a Supporting the handleset with one hand, unscrew and remove the lower #10-32 x 2½" flat head screw and screw cover backplate. Remove the handleset.

Tahoe



5b Supporting the handleset with one hand, unscrew and remove the lower #10-32 x 2½" oval head screw and decorative screw base. Remove the handleset.

3 Replace the Thumblift Assembly

The next steps should be performed on a padded surface such as a towel or blanket to prevent damage to your handleset's finish.

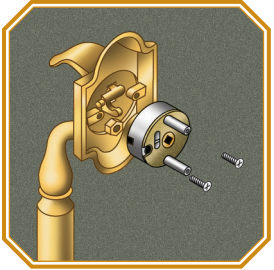

1 Remove the #6-32 x 7/16" flat head screws that secure the thumblift cartridge to the handleset. Discard the cartridge and the screws.

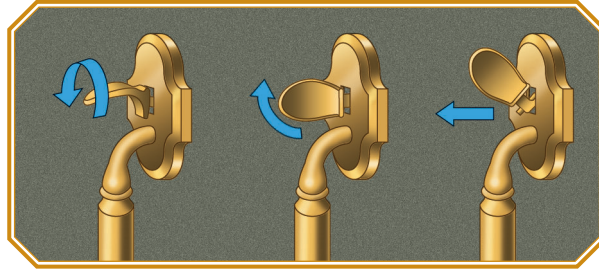

2 Remove the thumbpiece and discard it.
Helpful Hint: The thumbpiece cannot be pulled directly out. Instead, it must be turned from a horizontal to a vertical position and then angled to allow the lugs to fit through the slot in the handleset.

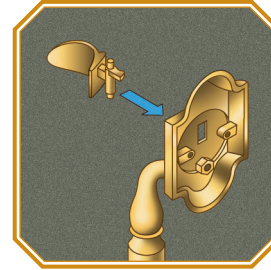

3 Insert the new thumbpiece into the handleset.
Helpful Hint: The new thumbpiece cannot be inserted directly into the handleset. Just reverse the steps followed to remove the old thumbpiece.

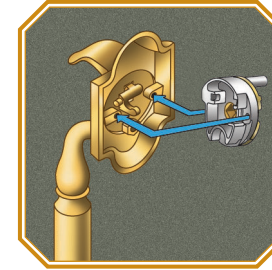

4 Position the new thumblift cartridge against the handleset, making sure the lugs on the thumbpiece seat into the pockets in the cartridge.

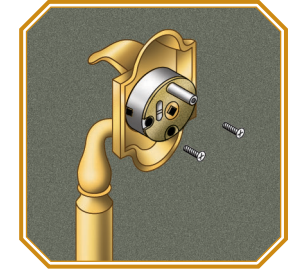

5 Locate the new thumblift cartridge over the screw posts and secure it with the new 6-32 x 7/16" flat head screws provided. The post on the cartridge should be at the top, and the face of the cartridge should be flush with the surface of the handleset.

Caution: These screws should be "hand tightened" only — do not use a power tool!



6 Screw the lower post into the threaded hole at the bottom of the thumblift cartridge and tighten.

4 Handleset Installation

Canterbury, Logan, Madison



1a Attach handle by inserting the #10-32 x 2½" flat head screw on inside of door through screw cover backplate and the lower hole. Leave screw loose for adjustment. Proceed to step 2.

Tahoe



1b Attach handle by inserting the #10-32 x 2¾" oval head screw on inside of door through decorative screw base and the lower hole. Leave screw loose for adjustment.

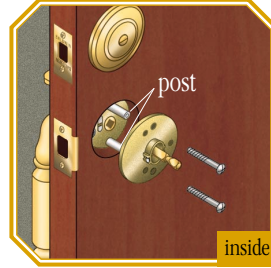

2 Place the new dummy inside adapter on the door, aligning the holes in adapter with posts on outside handleset. Secure with two new #10-32 x 1¼" truss head screws.

Canterbury, Logan, Madison



3a Position rosette onto dummy inside adapter and snap into place. If your rosette has a third slot (smaller), it should face down. Proceed to step 4a.



Tahoe



3b Position rosette over dummy inside adapter. Using rose retainer wrench, thread the rose retainer onto the threaded portion of the adapter. Align rosette edge with door edge and tighten. Proceed to step 4b.

Canterbury, Logan, Madison



4a Slide knob onto spindle with set screw hole down and toward hinges until it is flush with rosette. Insert set screw and tighten with Allen wrench. Knob/lever is secured when set screw enters V groove in spindle. Attach bottom screw cover.

Tahoe



4b Slide knob onto spindle with set screw hole down and toward hinges until it is flush with rosette. Insert set screw and tighten with Allen wrench. Knob/lever is secured when set screw enters V groove in spindle. Tighten the #10-32 x 2¾" oval head screw to secure the decorative screw base.