



## Latch & Strike Options

- F/FA Series Knobs
- F/FA Series Levers
- F/FA Series Grip Handlesets
- B Series Deadbolts



# Uncompromising quality, Unsurpassed flexibility.



Schlage locks are built using the toughest materials and the most advanced technology. Our products are backed by a lifetime guarantee, so you can be assured of the very best durability and performance. Schlage also gives you unsurpassed flexibility to ensure your products meet the unique requirements of your job.

While every Schlage product ships with a latch and strike to work in most applications, we help make installation at the jobsite even easier with the ability to choose the exact combination to match your specific door prep.

If our standard latch and strike combinations are not exactly what you need, just choose from the latch and strike options listed on the following pages.

## F Series Knobs and Levers



## FA Series Knobs and Levers



## F Series Grip Handlesets



## B Series Deadbolts



## Lockset Functions

<b>F51</b> Keyed Entry	<b>FA51</b> Keyed Entry
<b>F51CF</b> UL Rated Keyed Entry	<b>FA51CF</b> UL Rated Keyed Entry
<b>F54</b> Keyed Entry	<b>FA54</b> Keyed Entry
<b>F54CF</b> UL Rated Keyed Entry	<b>FA54CF</b> UL Rated Keyed Entry
<b>F80</b> Storeroom Lock	<b>FA80</b> Storeroom Lock
<b>F80CF</b> UL Rated Storeroom Lock	<b>FA80CF</b> UL Rated Storeroom Lock
<b>FE575</b> Keypad Entry w/AutoLock	<b>FE595</b> Keypad Entry w/Flex-Lock

## F SERIES DEAD LATCHES

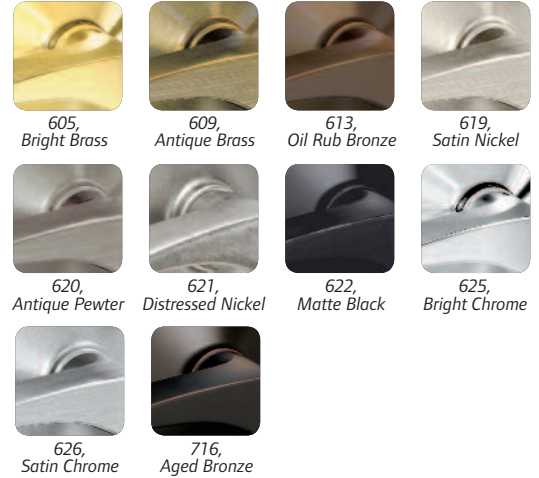

## Standard Latch & Strike Configurations

### Box Pack

Function	Std. Latch	Std. Strike
F51/F54/F80	16-211	10-063
FA51/FA54/FA80	16-211	10-063
FE575 KPL	16-211	10-063
FE595 KPL	16-211	10-063

### Visual Pack

Function	Std. Latch	Std. Strike
F51V	16-086	10-027
FE575V	16-086	10-027
FE595V	16-086	10-027

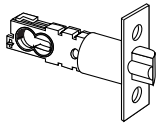

### Square Corner

Part Number: **16-207**  
 Faceplate Size: 1" x 2-1/4"  
 Latch Diameter: 7/8"  
 Backset: 2-3/8" or 2-3/4"  
 Application: F51, F54, F80, FA51, FA54, FA80  
 Finishes: 605, 609, 613, 619, 620, 621, 622, 625, 626, 716  
 Includes A501-878 adaptor for 1-1/8" faceplate

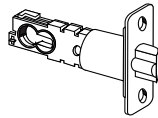

### 1/4" Radius Round Corner

Part Number: **16-209**  
 Faceplate Size: 1" x 2-1/4"  
 Latch Diameter: 7/8"  
 Backset: 2-3/8" or 2-3/4"  
 Application: F51, F54, F80, FA51, FA54, FA80  
 Finishes: 605, 609, 613, 619, 620, 621, 622, 625, 626, 716

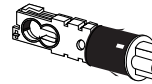

### Circular Drive-In

Part Number: **16-212**  
 Faceplate Size: Not Applicable  
 Latch Diameter: 7/8"  
 Backset: 2-3/8" or 2-3/4"  
 Application: F51, F54, F80, FA51, FA54, FA80  
 Finish: 626

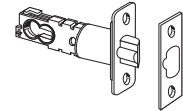

### Dual Option

Part Number: **16-234**  
 Faceplate Size: 1" x 2-1/4"  
 Latch Diameter: 7/8"  
 Backset: 2-3/8" or 2-3/4"  
 Application: F51, F54, F80, FA51, FA54, FA80  
 Finishes: 605, 609, 613, 619, 620, 621, 622, 625, 626, 716  
 Attached 1/4" radius round corner, includes square corner faceplate

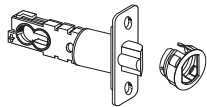

### Dual Option

Part Number: **16-086**  
 Faceplate Size: 1" x 2-1/4"  
 Latch Diameter: 7/8"  
 Backset: 2-3/8" or 2-3/4"  
 Application: F51, F54, F80, FA51, FA54, FA80  
 Finishes: 605, 609, 613, 619, 620, 621, 622, 625, 626, 716  
 Attached 1/4" radius round corner, includes drive-in faceplate

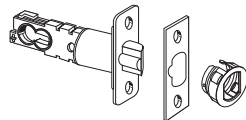

### Triple Option

Part Number: **16-211**  
 Faceplate Size: 1" x 2-1/4"  
 Latch Diameter: 7/8"  
 Backset: 2-3/8" or 2-3/4"  
 Application: F51, F54, F80, FA51, FA54, FA80  
 Finishes: 605, 609, 613, 619, 620, 621, 622, 625, 626, 716  
 Attached 1/4" radius round corner, includes square corner and drive-in faceplates

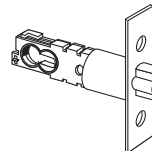

### 5" Square Corner

Part Number: **16-126**  
 Faceplate Size: 1" x 2-1/4"  
 Latch Diameter: 7/8"  
 Backset: 5"  
 Application: F51, F54, F80, FA51, FA54, FA80  
 Finishes: 605, 609, 613, 619, 620, 621, 622, 625, 626, 716  
 Includes A501-878 adaptor for 1-1/8" faceplate

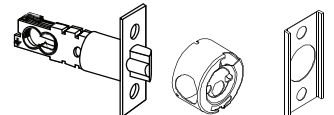

### UL Rated Square Corner

Part Number: **16-203**  
 Faceplate Size: 1" x 2-1/4"  
 Latch Diameter: 7/8"  
 Backset: 2-3/8" or 2-3/4"  
 Application: F51CF, F54CF, F80CF, FA51CF, FA54CF, FA80CF  
 Finishes: 605, 609, 613, 619, 620, 621, 622, 625, 626, 716  
 Includes A501-878 adaptor for 1-1/8" faceplate and Fire Cup

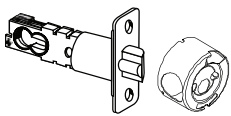

### UL Rated 1/4" Radius Round Corner

Part Number: **16-204**  
 Faceplate Size: 1" x 2-1/4"  
 Latch Diameter: 7/8"  
 Backset: 2-3/8" or 2-3/4"  
 Application: F51CF, F54CF, F80CF, FA51CF, FA54CF, FA80CF  
 Finishes: 605, 609, 613, 619, 620, 621, 622, 625, 626, 716  
 Includes A501-878 adaptor for 1-1/8" faceplate and Fire Cup

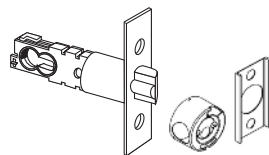

### UL Rated 5" Square Corner

Part Number: **16-132**  
 Faceplate Size: 1" x 2-1/4"  
 Latch Diameter: 7/8"  
 Backset: 5"  
 Application: F51CF, F54CF, F80CF, FA51CF, FA54CF, FA80CF  
 Finishes: 605, 609, 613, 619, 620, 621, 622, 625, 626, 716  
 Includes A501-878 adaptor for 1-1/8" faceplate and Fire Cup

# F SERIES GRIP LATCHES

## Lockset Functions

- F58** Exterior Entrance
- F59** Entrance Interior
- F60** Keyed 1-Side
- F62** Keyed 2-Sides

## Standard Latch & Strike Configurations

### Box Pack

Function	Std. Latch	Std. Strike
F59	12-326	10-269
F60	12-326	10-269
F62	12-326	10-269

### Visual Pack

Function	Std. Latch	Std. Strike
F60V	12-322	10-115

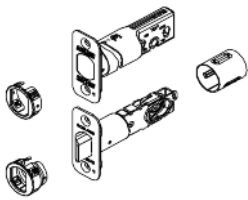
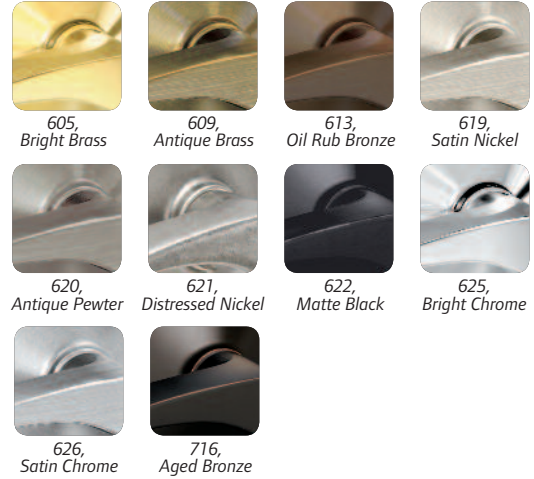

**Dual Option**  
(16-080 & 12-321)

Part Number: **12-322**  
 Faceplate Size: 1" x 2-1/4"  
 Spring Latch Diameter: 7/8"  
 Deadbolt Latch Diameter: 1"  
 Backset: 2-3/8" or 2-3/4"  
 Finishes: 605, 609, 613, 619, 620, 621, 622, 625, 626, 716

Attached 1/4" radius round corner, includes drive-in faceplate

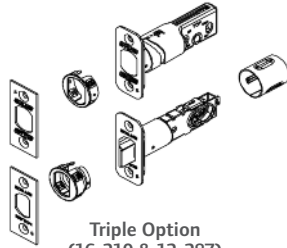

**Triple Option**  
(16-210 & 12-287)

Part Number: **12-326**  
 Faceplate Size: 1" x 2-1/4"  
 Spring Latch Diameter: 7/8"  
 Deadbolt Latch Diameter: 1"  
 Backset: 2-3/8" or 2-3/4"  
 Finishes: 605, 609, 613, 619, 620, 621, 622, 625, 626, 716

Attached 1/4" radius round corner, includes square corner and drive-in faceplates

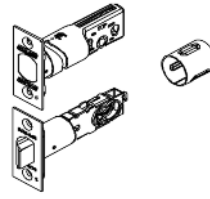

**Square Corner**  
(16-200 & 12-288)

Part Number: **12-323**  
 Faceplate Size: 1" x 2-1/4"  
 Spring Latch Diameter: 7/8"  
 Deadbolt Latch Diameter: 1"  
 Backset: 2-3/8" or 2-3/4"  
 Finishes: 605, 609, 613, 619, 620, 621, 622, 625, 626, 716

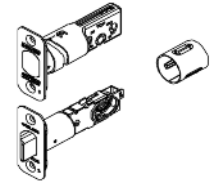

**1/4" Radius Round Corner**  
(16-201 & 12-289)

Part Number: **12-324**  
 Faceplate Size: 1" x 2-1/4"  
 Spring Latch Diameter: 7/8"  
 Deadbolt Latch Diameter: 1"  
 Backset: 2-3/8" or 2-3/4"  
 Finishes: 605, 609, 613, 619, 620, 621, 622, 625, 626, 716

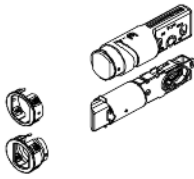

**Circular Drive-In**  
(16-202 & 12-290)

Part Number: **12-325**  
 Faceplate Size: Not Applicable  
 Spring Latch Diameter: 7/8"  
 Deadbolt Latch Diameter: 1"  
 Backset: 2-3/8" or 2-3/4"  
 Finish: 626

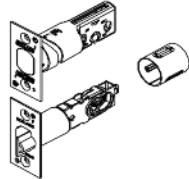

**UL Rated 1-1/8" Square Corner**  
(16-203 & 12-296)

Part Number: **12-332**  
 Faceplate Size: 1-1/8" x 2-1/4"  
 Spring Latch Diameter: 7/8"  
 Deadbolt Latch Diameter: 1"  
 Backset: 2-3/8" or 2-3/4"  
 Finishes: 605, 609, 613, 619, 620, 621, 622, 625, 626, 716

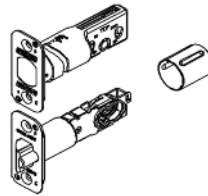

**UL Rated 1/4" Radius Round Corner**  
(16-204 & 12-397)

Part Number: **12-333**  
 Faceplate Size: 1" x 2-1/4"  
 Spring Latch Diameter: 7/8"  
 Deadbolt Latch Diameter: 1"  
 Backset: 2-3/8" or 2-3/4"  
 Finishes: 605, 609, 613, 619, 620, 621, 622, 625, 626, 716

**Lockset Functions**

- FA358** Exterior Entrance
- FA359** Entrance Interior
- FA360** Keyed 1-Side
- FA362** Keyed 2-Sides

**Standard Latch & Strike Configurations**

**Box Pack**

Function	Std. Latch	Std. Strike
FA359	16-235	10-248
FA360	16-235	10-248
FA362	16-235	10-248

**Visual Pack**

Function	Std. Latch	Std. Strike
FA360 V	16-235	10-254

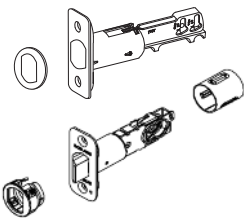
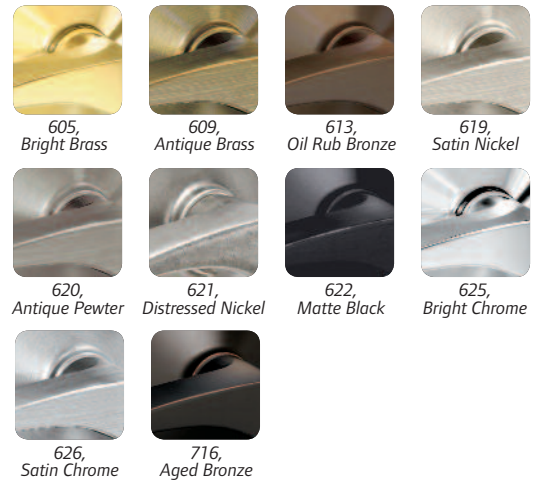

**Dual Option**  
(16-233 & 12-313)

Part Number: **16-242**  
 Faceplate Size: 1" x 2-1/4"  
 Spring Latch Diameter: 7/8"  
 Deadbolt Latch Diameter: 7/8"  
 Backset: 2-3/8" or 2-3/4"  
 Finishes: 605, 609, 613, 619, 620, 621, 622, 625, 626, 716

Attached 1/4" radius round corner, includes drive-in faceplate

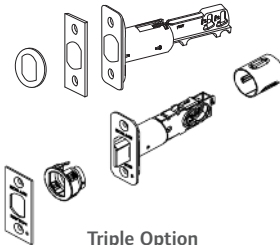

**Triple Option**  
(16-210 & 12-300)

Part Number: **16-235**  
 Faceplate Size: 1" x 2-1/4"  
 Spring Latch Diameter: 7/8"  
 Deadbolt Latch Diameter: 7/8"  
 Backset: 2-3/8" or 2-3/4"  
 Finishes: 605, 609, 613, 619, 620, 621, 622, 625, 626, 716

Attached 1/4" radius round corner, includes square corner and drive-in faceplates

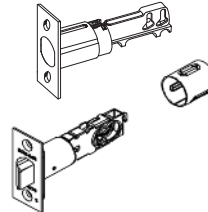

**Square Corner**  
(16-200 & 12-304)

Part Number: **16-236**  
 Faceplate Size: 1" x 2-1/4"  
 Spring Latch Diameter: 7/8"  
 Deadbolt Latch Diameter: 7/8"  
 Backset: 2-3/8" or 2-3/4"  
 Finishes: 605, 609, 613, 619, 620, 621, 622, 625, 626, 716

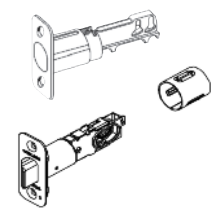

**1/4" Radius Round Corner**  
(16-201 & 12-302)

Part Number: **16-237**  
 Faceplate Size: 1" x 2-1/4"  
 Spring Latch Diameter: 7/8"  
 Deadbolt Latch Diameter: 7/8"  
 Backset: 2-3/8" or 2-3/4"  
 Finishes: 605, 609, 613, 619, 620, 621, 622, 625, 626, 716

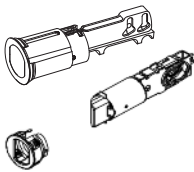

**Circular Drive-In**  
(16-202 & 12-303)

Part Number: **16-238**  
 Faceplate Size: Not Applicable  
 Spring Latch Diameter: 7/8"  
 Deadbolt Latch Diameter: 7/8"  
 Backset: 2-3/8" or 2-3/4"  
 Finish: 626

**FA Series Handleset Default Strike**

Part Number: **10-248**  
 Square Corner and Round Corner Latch Strike,  
 Square Corner Deadbolt Strike

Includes latch strike 10-063 and deadbolt strike 10-094

# F SERIES SPRING LATCHES

## Lockset Functions

<b>F10</b> Passage	<b>FA10</b> Passage
<b>F10CF</b> UL Rated Passage	<b>FA10CF</b> UL Rated Passage
<b>F40</b> Bath/Bed	<b>FA40</b> Bath/Bed
<b>F40CF</b> UL Rated Bath/Bed	<b>FA40CF</b> UL Rated Bath/Bed

## Standard Latch & Strike Configurations

### Box Pack

Function	Std. Latch	Std. Strike
F10	16-080	10-027
FA10	16-080	10-027
F40	16-080	10-027
FA40	16-080	10-027

### Visual Pack

Function	Std. Latch	Std. Strike
F10V	16-080	10-027
F40V	16-080	10-027

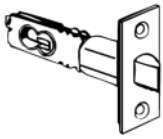
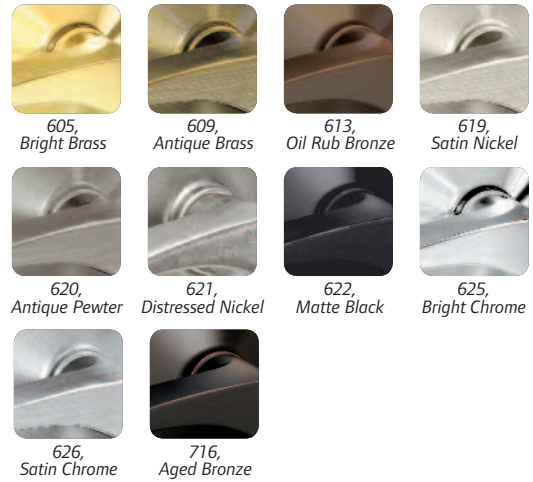

Square Corner

Part Number: **16-200**  
 Faceplate Size: 1" x 2-1/4"  
 Latch Diameter: 7/8"  
 Backset: 2-3/8" or 2-3/4"  
 Application: F10, FA10, F40, FA40  
 Finishes: 605, 609, 613, 619, 620, 621, 622, 625, 626, 716

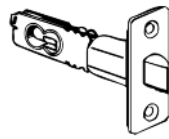

1/4" Radius Round Corner

Part Number: **16-201**  
 Faceplate Size: 1" x 2-1/4"  
 Latch Diameter: 7/8"  
 Backset: 2-3/8" or 2-3/4"  
 Application: F10, FA10, F40, FA40  
 Finishes: 605, 609, 613, 619, 620, 621, 622, 625, 626, 716

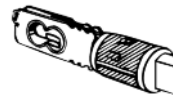

Circular Drive-In

Part Number: **16-202**  
 Faceplate Size: Not Applicable  
 Latch Diameter: 7/8"  
 Backset: 2-3/8" or 2-3/4"  
 Application: F10, FA10, F40, FA40  
 Finish: 626

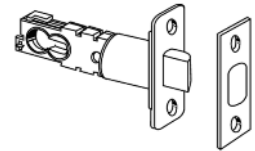

Dual Option

Part Number: **16-233**  
 Faceplate Size: 1" x 2-1/4"  
 Latch Diameter: 7/8"  
 Backset: 2-3/8" or 2-3/4"  
 Application: F10, FA10, F40, FA40  
 Finishes: 605, 609, 613, 619, 620, 621, 622, 625, 626, 716

Attached 1/4" radius round corner, includes square corner faceplate

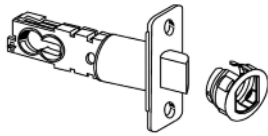

Dual Option

Part Number: **16-080**  
 Faceplate Size: 1" x 2-1/4"  
 Latch Diameter: 7/8"  
 Backset: 2-3/8" or 2-3/4"  
 Application: F10, FA10, F40, FA40  
 Finishes: 605, 609, 613, 619, 620, 621, 622, 625, 626, 716

Attached 1/4" radius round corner, includes drive-in faceplate

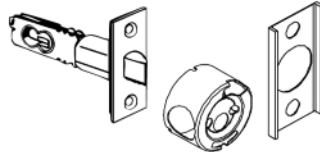

UL Rated Square Corner

Part Number: **16-244**  
 Faceplate Size: 1" x 2-1/4"  
 Latch Diameter: 7/8"  
 Backset: 2-3/8" or 2-3/4"  
 Application: F10CF, FA10CF, F40CF, FA40CF  
 Finishes: 605, 609, 613, 619, 620, 621, 622, 625, 626, 716

Includes A501-878 adaptor for 1-1/8" faceplate and Fire Cup

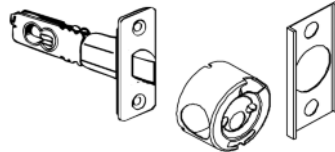

UL Rated 1/4" Radius Round Corner

Part Number: **16-245**  
 Faceplate Size: 1" x 2-1/4"  
 Latch Diameter: 7/8"  
 Backset: 2-3/8" or 2-3/4"  
 Application: F10CF, FA10CF, F40CF, FA40CF  
 Finishes: 605, 609, 613, 619, 620, 621, 622, 625, 626, 716

Includes A501-878 adaptor for 1-1/8" faceplate and Fire Cup



**Lockset Functions**

- B60** Sgl Cyl Deadbolt
- B62** Dbl Cyl Deadbolt
- B80** Door Bolt
- B81** 1-Sided Sgl Cyl Deadbolt
- BE365** Keypad Sgl Cyl Deadbolt
- BE367** I-Button Sgl Cyl Deadbolt
- BE369** Link Sgl Cyl Deadbolt

**Standard Latch & Strike Configurations**

**Box Pack**

Function	Std. Latch	Std. Strike
B60	12-287	10-116
B62	12-287	10-116
BE365 KPD	12-287	10-116
BE367 SPED	12-287	10-116
BE369-LINK	12-287	10-116

**Visual Pack**

Function	Std. Latch	Std. Strike
B60V	12-321	10-116
B62V	12-321	10-116
BE365V	12-321	10-116

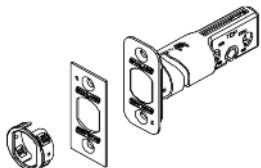
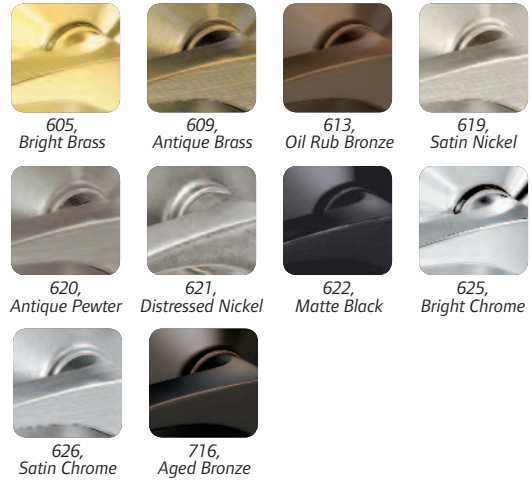

**Triple Option**

Part Number: **12-287**  
 Faceplate Size: 1" x 2-1/4"  
 Latch Diameter: 1"  
 Backset: 2-3/8" or 2-3/4"  
 Finishes: 605, 609, 613, 619, 620, 621, 622, 625, 626, 716

Attached 1/4" radius round corner, also includes square corner and drive-in faceplates

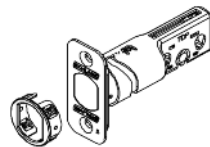

**Dual Option**

Part Number: **12-321**  
 Faceplate Size: 1" x 2-1/4"  
 Latch Diameter: 1"  
 Backset: 2-3/8" or 2-3/4"  
 Finishes: 605, 609, 613, 619, 620, 621, 622, 625, 626, 716

Attached 1/4" radius round corner, also includes drive-in faceplate

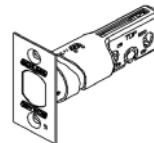

**Square Corner**

Part Number: **12-288**  
 Faceplate Size: 1" x 2-1/4"  
 Latch Diameter: 1"  
 Backset: 2-3/8" or 2-3/4"  
 Finishes: 605, 609, 613, 619, 620, 621, 622, 625, 626, 716

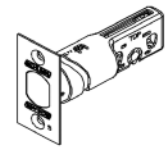

**Square Corner**

Part Number: **12-291**  
 Faceplate Size: 1-1/8" x 2-1/4"  
 Latch Diameter: 1"  
 Backset: 2-3/8" or 2-3/4"  
 Finishes: 605, 609, 613, 619, 620, 621, 622, 625, 626, 716

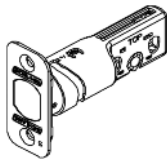

**1/4" Radius Round Corner**

Part Number: **12-289**  
 Faceplate Size: 1" x 2-1/4"  
 Latch Diameter: 1"  
 Backset: 2-3/8" or 2-3/4"  
 Finishes: 605, 609, 613, 619, 620, 621, 622, 625, 626, 716

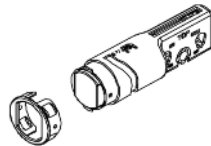

**Circular Drive-In**

Part Number: **12-290**  
 Faceplate Size: Not Applicable  
 Latch Diameter: 1"  
 Backset: 2-3/8" or 2-3/4"  
 Finish: 626

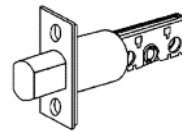

**5" Square Corner**

Part Number: **12-633**  
 Faceplate Size: 1-1/8" x 2-1/4"  
 Latch Diameter: 1"  
 Backset: 5"  
 Finishes: 605, 609, 613, 619, 620, 621, 622, 625, 626, 716

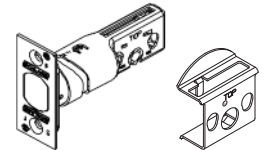

**UL Square Corner**

Part Number: **12-294**  
 Faceplate Size: 1" x 2-1/4"  
 Latch Diameter: 1"  
 Backset: 2-3/8" or 2-3/4"  
 Finishes: 605, 609, 613, 619, 620, 621, 622, 625, 626, 716

Includes Fire Cup

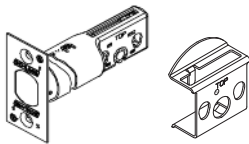

**UL Square Corner**

Part Number: **12-296**  
 Faceplate Size: 1-1/8" x 2-1/4"  
 Latch Diameter: 1"  
 Backset: 2-3/8" or 2-3/4"  
 Finishes: 605, 609, 613, 619, 620, 621, 622, 625, 626, 716

Includes Fire Cup

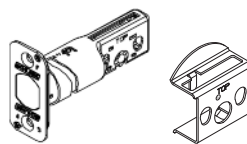

**1/4" Radius Round Corner**

Part Number: **12-397**  
 Faceplate Size: 1" x 2-1/4"  
 Latch Diameter: 1"  
 Backset: 2-3/8" or 2-3/4"  
 Finishes: 605, 609, 613, 619, 620, 621, 622, 625, 626, 716

Includes Fire Cup

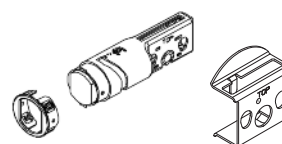

**UL Circular Drive-In**

Part Number: **12-316**  
 Faceplate Size: Not Applicable  
 Latch Diameter: 1"  
 Backset: 2-3/8" or 2-3/4"  
 Finish: 626

Includes Fire Cup

## F Series Strikes - For F51, F54, F80, FA51, FA54, FA80, F10, FA10, F40 and FA40 Products



**Square Corner T Strike**

Part: **10-001**  
Size: 1-1/8" x 2-3/4"

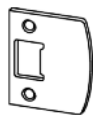

**Square Corner Full Lip Strike**

Part: **10-026**  
Size: 2-1/4" x 1-5/8"

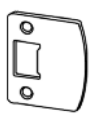

**1/4" Radius Corner Full Lip Strike**

Part: **10-027**  
Size: 2-1/4" x 1-5/8"

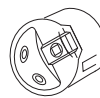

**Circular Adjustable**

Part: **10-058**  
Size: 1-3/4" Diameter

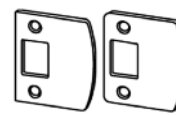

**Dual Strikes (10-026 & 10-027)**

Part: **10-063**  
Size: 2-1/4" x 1-5/8"



**ANSI Square Corner T Strike**

Part: **10-025**  
Size: 1-1/4" x 4-7/8"

## B Series Strikes - For B60, B62, B80, B81, BE365, BE367 and BE369 Deadbolts



**Drive-In Circular Strike**

Part: **10-064**  
Size: 1-3/16" Diameter



**1/4" Radius Corner Full Lip Strike**

Part: **10-092**  
Size: 1-5/8" x 2-1/4"



**ANSI T Strike**

Part: **10-087**  
Size: 1-1/4" x 4-7/8"



**Square Corner Strike**

Part: **10-094**  
Size: 1-1/8" x 2-3/4"



**1/4" Radius Round Corner Strike**

Part: **10-103**  
Size: 1" x 2-1/4"



**1/4" Radius Round Corner 4-Hole Strike**

Part: **10-104**  
Size: 1-1/4" x 3-5/8"



**1/4" Radius Round Corner Full Lip Strike**

Part: **10-113**  
Size: 1-1/8" x 2-3/4"



**1/4" Radius Round Corner Strike**

Part: **10-116**  
Size: 1-1/8" x 2-3/4"



**1/4" Radius Round Corner Strike Frame Reinforcer**

Part: **B502-914**  
Size: 1-1/8" x 2-3/4"

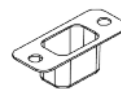

**Plastic Black Dust Box for Standard Strike**

Part: **B520-283**  
Size: 1-1/8" x 2-3/4"



**Metal Dust Box for Standard Strike**

Part: **B520-622**  
Size: 1-1/8" x 2-3/4"

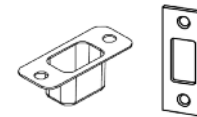

**Square Corner Strike and Plastic Dust Box (10-094 & B520-283)**

Part: **10-081**  
Size: 1-1/8" x 2-3/4"

## Handleset Strikes

### Part 10-269, includes:

(1) 1/4" Radius Round Corner Deadbolt Strike (10-116), (1) Square Corner Full Lip Strike (10-026), (1) 1/4" Radius Round Corner Full Lip Strike (10-027)

### Part 10-115, includes:

(1) 1/4" Radius Round Corner Deadbolt Strike (10-116), (1) 1/4" Radius Round Corner Full Lip Strike (10-027)

### Part 10-265, includes:

(1) Square Corner Deadbolt Strike (10-094), (1) Square Corner Full Lip Strike (10-026), (1) 1/4" Radius Round Corner Full Lip Strike (10-027)

### Part 10-254, includes:

(1) Square Corner Deadbolt Strike (10-094), (1) Square Corner Full Lip Strike (10-026)

### Part 10-258, includes:

(1) Drive-In Circular Deadbolt Strike (10-064), (1) Circular Drive-In Strike (10-058)

### Part 10-256, includes:

(1) Drive-In Circular Deadbolt Strike (10-064), (1) 1/4" Radius Round Corner Full Lip Strike (10-027)

### Part 10-253, includes:

(1) Drive-In Circular Deadbolt Strike (10-064), (1) Square Corner Full Lip Strike (10-026)

### Part 10-245, includes:

(1) 1/4" Radius Round Corner Full Lip Tall Deadbolt Strike (10-113), (1) Square Corner Full Lip Strike (10-026), (1) 1/4" Radius Round Corner Full Lip Strike (10-027)

### Part 10-259, includes:

(1) Square Corner Full Lip Deadbolt Strike (10-095), (1) Square Corner Full Lip Strike (10-026)

### Part 10-257, includes:

(1) 1/4" Radius Round Corner Full Lip Deadbolt Strike (10-092), (1) 1/4" Radius Round Corner Full Lip Strike (10-027)



Ingersoll Rand Residential Solutions, a business comprised of well-known brands like Schlage and Trane, delivers safety, comfort and efficiency to homeowners throughout North America. Our quality products, services and solutions include mechanical and electronic locks, heating and air conditioning systems, indoor air quality solutions, advanced controls, portable security systems and remote home management.

800-847-1864

www.schlage.com www.ingersollrand.com

©2010 Ingersoll-Rand Company MR-1975