

P Series Handleset Installation Instructions



The instructions provide the information on how to install your lock properly. Read the instructions carefully before installation.

BEFORE PROCEEDING:

1. CHECK THICKNESS OF YOUR DOOR

Be sure that your door thickness is 1-3/8" (35mm)–1-3/4" (45mm) or 1-11/16" (43mm)–2-1/4" (58mm).

2. CHECK BACKSET OF YOUR LOCK

Backset, 2-3/8" (60mm) or 2-3/4" (70mm), is indicated on packaging box, some models are supplied with adjustable latch.

3. CHECK BACKSET OF YOUR DOOR

Backset is the distance measured from door edge to center of lock, either 2-3/8" (60mm) or 2-3/4" (70mm).

4. MATCH BACKSET OF YOUR LOCK WITH BACKSET OF YOUR DOOR

Make sure your lock has the same backset as your door. For lock supplied with adjustable latch, you may adjust the backset if necessary according to instructions of LATCH BACKSET ADJUSTMENT.

1. MARK DOOR

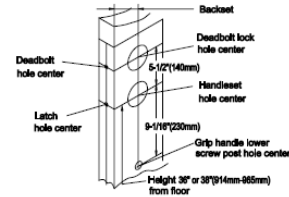

- Start approximately 36" or 38" (914mm-965mm) from floor, select backset, 2-3/8" (60mm) or 2-3/4" (70mm), fold and apply template on high edge of beveled door.
- Mark hole center on door face for deadbolt lock.
- Mark hole center on door face for handleset.
- Mark hole center on door face for grip handle lower screw post.
- Mark two hole centers in door edge for latches.

2. BORE FIVE HOLES

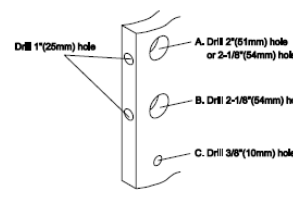

- Drill a 2" (51mm) or 2-1/8" (54mm) hole through door face.
 - Drill a 2-1/8" (54mm) hole through door face.
 - Drill a 3/8" (10mm) hole through door face.
 - Drill two 1" (25mm) holes in door edge.
- Note: It is recommended to drill holes from both sides of door in A, B & C to avoid splitting.

3. INSTALL LATCH AND DEADBOLT

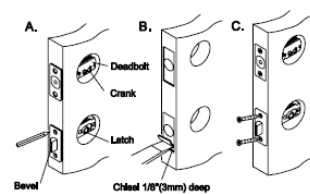

- Insert latch (deadbolt) into hole in door edge, keeping latch face parallel to edge of door. Mark outline of latch face and remove latch.
 - Chisel 1/8" (3mm) deep or until latch face is flush with door edge.
 - Insert latch (deadbolt) into hole and tighten wood screws.
- Note: 1. Latchbolt bevel must face to closing direction.
2. Crank hole must be in down position.

4. MARK JAMB AND OUTLINE OF STRIKES

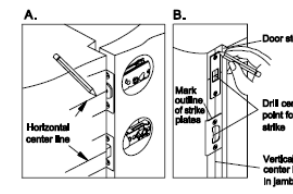

- Close door until latchbolt touches door jamb.
- Mark horizontal center line along latch face.
- Measure one half of door thickness from door stop and mark vertical center line.
- Extend horizontal center line and vertical center line, then mark center points for strikes.
- Place strikes in position and mark outline of strikes and remove strikes.

5. DRILL HOLES AND INSTALL STRIKES

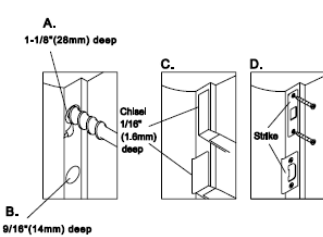

- Drill a 1" (25mm) hole, 1-1/8" (28mm) deep in door jamb at the upper center for deadbolt.
- Drill a 1" (25mm) hole, 9/16" (14mm) deep in door jamb at the lower center for latch.
- Chisel outline for strikes 1/16" (1.6mm) deep or until strikes are flush with door jamb.
- Install strikes and tighten wood screws.

6. INSTALL HANDLESET

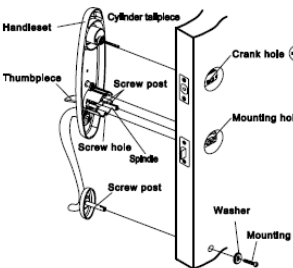

- Place handleset onto door by inserting spindle and 2 screw posts through latch from outside of door as shown, and cylinder tailpiece through latch crank hole at the same time. Press thumbpiece to see if latchbolt can retract.
- Insert mounting screw through washer from inside of door, but do not tighten.

7. INSTALL INSIDE KNOB (LEVER) ASSEMBLY

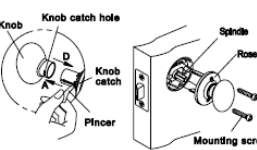

- Press knob catch by plier to take out knob.
- Insert inside knob (lever) assembly, so holes in rose line up with screw posts, and spindle is engaged with inside mechanism. Insert mounting screws into hole in rose, tighten screws for handleset.
- Adjust all mounting screws as required for smooth operation.
- Press knob catch by plier again. Install knob through knob catch hole to clasp knob.

8. INSTALL SINGLE CYLINDER

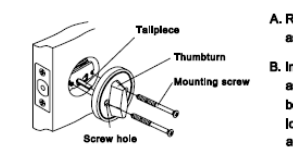

- Rotate thumbturn to vertical position and slip thumbturn assembly onto tailpiece.
- Insert two mounting screws through holes on thumbturn assembly and deadbolt, engaging screw holes in outside body, then tighten to snug fit. Do not overtighten. Test lock for smooth operation. If not smooth, loosen screws, adjust cylinder and tighten firmly.

9. INSTALL DOUBLE CYLINDER

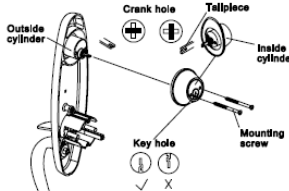

- Insert the inside tailpiece into crank hole vertically (as shown in figure).
Note: key hole in downward (as shown in figure).
- The inside tailpiece should be inserted crosswise into the outside tailpiece.
- Insert two mounting screws through countersunk holes on inside cylinder body and deadbolt, engaging screw holes in outside cylinder body and tightening to snug fit. Do not overtighten.
- Test lock for smooth operation. If not smooth, loosen screws, adjust cylinder and tighten firmly.

LATCH BACKSET ADJUSTMENT

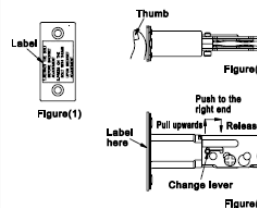

- Make sure there's a label on the latch face as shown in figure (1). If no label found, as shown in figure (2), press latchbolt with thumb.
- To adjust backset from 2-3/8" (60mm) to 2-3/4" (70mm), push change lever up against the top. Pull it right all the way out and then release it. The latch is now set for 2-3/4" (70mm). To adjust backset from 2-3/4" (70mm) to 2-3/8" (60mm), push change lever up against the top. Pull it left all the way out and then release it. The latch is now set for 2-3/8" (60mm).

In case latch bolt jams caused by label missing or improper operation, return it to proper position by the following steps:

- Remove rivet sleeve with screw driver and pull flat head rivet out. Press the latch bolt with thumb to retract it completely.
- Insert the flat head rivet into proper position as per the backset required and cover the rivet sleeve.

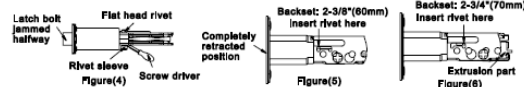

ADJUST DEADBOLT

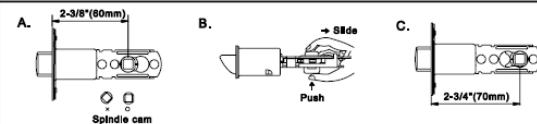

- Adjustable latch was preset at 2-3/8" (60mm) backset position.
- Keep spindle cam in correct position as illustrated. Adjust by grasping the spindle cam between thumb and index, slightly push down spindle cam and slide to right side.
- The latch is now set for 2-3/4" (70mm) backset. To re-adjust latch back to 2-3/8" (60mm) backset, just push slide extension back to left side.

ADJUST LATCH



- Mortise-in latch.
- Rotate 20°.
- Drive-in latch.

ADJUST 4-WAY LATCH